

### Pump

Multistage centrifugal pump  
 Liquid pumped temperature up to 60°C  
 Clean water with little impurities, non-aggressive liquid

### Motor

Single phase/Three-phase, 50Hz/60Hz  
 Insulation class: 130  
 Protection class: IP44  
 Ambient temperature up to 40°C  
 With thermal overload protection  
 Copper winding



### Hydraulic Performance Curve

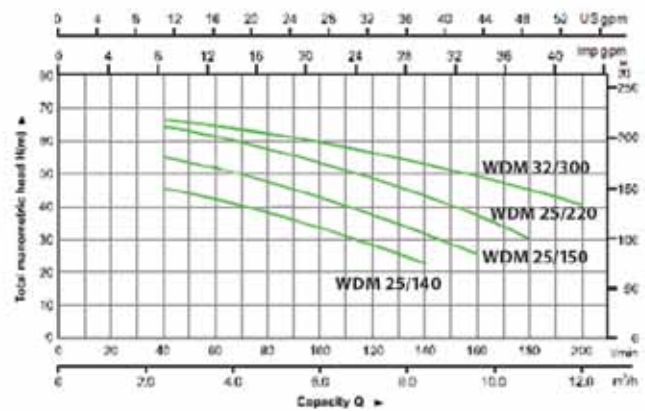

### Parts Information of Centrifugal Pump

Part	Material	Remark
1 Pump body	Cast iron	Electrophoretic treatment
2 Impeller	Brass	
3 Eliminator	Cast iron	
4 Impeller	Brass	
5 Mechanical seal	Silicon carbide/Graphite	
6 Support	Cast iron	Electrophoretic treatment
7 Front cover	Cast iron	
8 Bearing	High quality	
9 Rotor	Cold-rolled sheet	
10 Stator	Aluminum casing	Cold-rolled sheet stator
11 End plate	Aluminum	
12 Fan	Noryl	
13 Fan cover	Iron	
14 Capacitor	High quality	

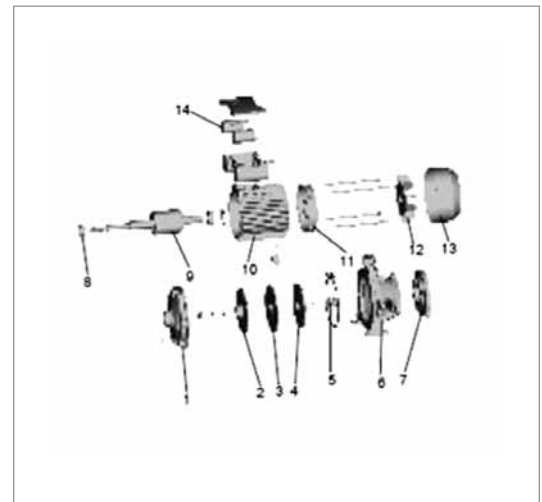

### Specifications

Model	Power		Inlet/Outlet	Max. Flow (L/min)	Max. Head (m)	Max. Suct (m)
	(kW)	(HP)				
WDM 25/140	1.5	2.0	1½"x1"	160	47	8
WDM 25/150	1.5	2.0	1½"x1"	180	58	8
WDM 25/220	2.2	3.0	1½"x1"	200	68	8
WDM 32/300	3.0	4.0	1½"x1¼"	250	70	8